



# CORNERSTONE



# CORNERSTONE SPECS

LIMITED LIFETIME WARRANTY †

## Panel Styles

23/24 gauge steel. Optional wide center stile available.

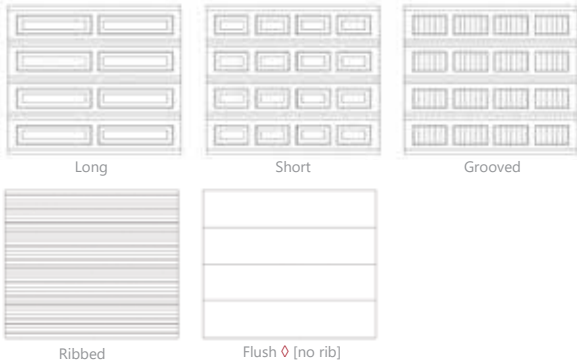

## Insulation

Add insulation for thermal efficiency, noise reduction, durability, and minimal upkeep.



Steel + Insulation + Vinyl



Steel + Insulation + Steel



Steel + 2 Insulation Layers + Steel

## Window Tint

Insulated glass options are available for most window types. Glass and acrylic have different tints.

### Glass/Acrylic

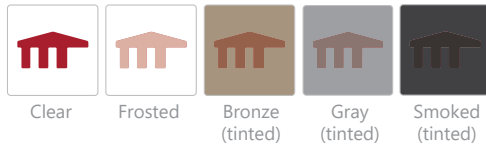

### Laminate

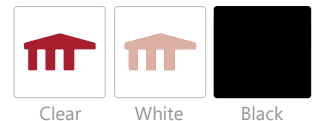

## Hardware

Includes roller, track and accessories for a strong and lasting door system.

### Martin Premium Hardware Package



Limited Lifetime Warranty †

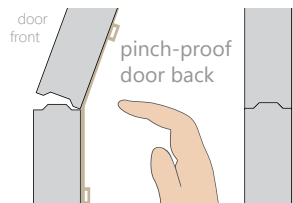

### Martin Standard Hardware Package



5 Year Warranty †

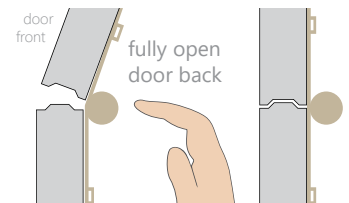

## Standard Colors

Long-Lasting baked-on enamel paint.

### Paint



### Wood Grain

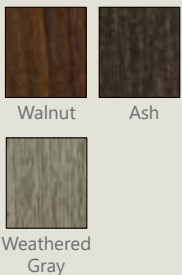

\*\*\*  
Please obtain physical samples before ordering.  
\*\*\*

## Popular Powder Coat Finishes<sup>^</sup>

### Solid

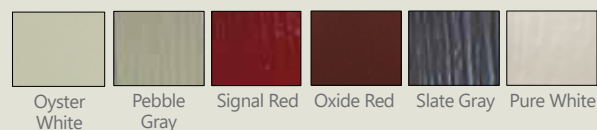
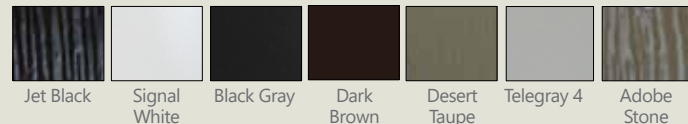

### Metallic



† See manufacturer's written warranty for details and limitations.

◊ Flush doors available in i4 insulation only.

^ Powder coated doors must be insulated.

CONTACT YOUR MARTIN DOOR DEALER TODAY

## Door Builder

Use your own home photo to configure a custom garage door in minutes!



2828 S 900 W, Salt Lake City, UT 84119  
1-800-388-9310  
[martindoor.com](http://martindoor.com)



MADE IN USA  
SINCE 1936